

# Side-By-Side Refrigerator INSTALLATION TIPS

## HAND TRUCKING

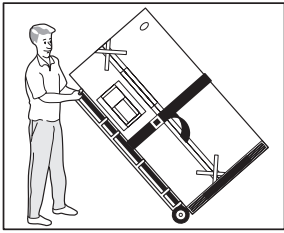

- Load refrigerator from side of cabinet only.
- Do not run retaining straps over handles.
- Do not over-tighten retaining straps.
- Never use refrigerator handles to move the refrigerator.
- Remove tape from doors only after unit is in place.

## SHIPPING CLIP REMOVAL

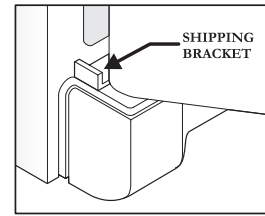

The Shipping Bracket will usually disengage when the door is opened the first time. If it **DOES NOT** disengage, remove it with pliers, taking care not to damage the finish.

## DOOR ADJUSTMENT

1. Open doors and remove toe grille by pulling straight off.
2. Use a 1/2 inch wrench to raise or lower front rollers until doors are even across the top.
3. All four corners should rest firmly on a solid floor.
4. Line up bottom toe grille tabs with holes and push straight on.

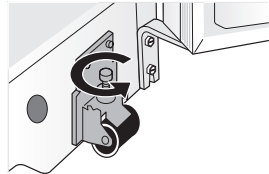

Turn bolt counter-clockwise to lower.

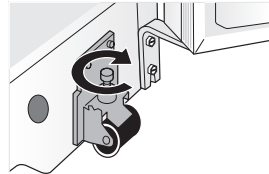

Turn bolt clockwise to raise.

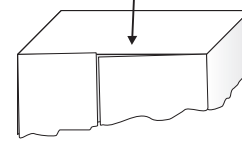

If refrigerator door is lower than freezer door, turn right front roller bolt clockwise.

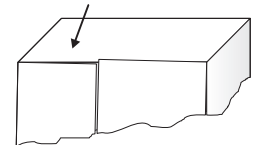

If freezer door is lower than refrigerator door, turn left front roller bolt clockwise.

## DOOR HANDLE & TRIM REMOVAL

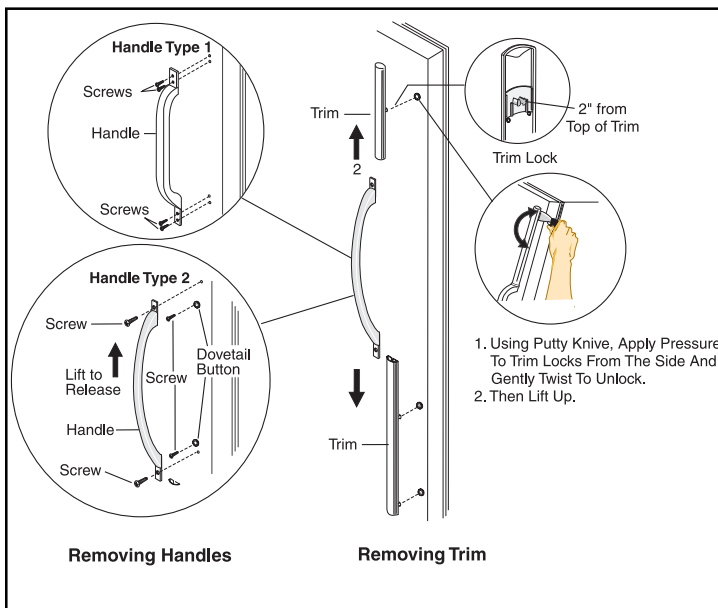

### To Remove Top Trim

1. Using a putty knife, carefully insert blade under trim at top, about 1" in. Slide blade down until you find trim lock, about 2" from top. Carefully twist and lift blade to release trim lock.
2. Grasp trim and push up and away from handle, using a slight side-to-side motion to remove trim.

### To Remove Bottom Trim

3. Repeat Step 1, starting at bottom, to release lower trim lock on bottom trim.
4. To release second trim lock on bottom trim, insert putty knife in about 1" and slide blade until you hit trim lock. Again, twist and lift blade to release lock.

### To Remove Door Handles

- 5a. *Door Handle Type 1*: Remove screws.
- 5b. *Door Handle Type 2*: Remove both screws and lift up on handle to release from dovetail buttons under handle.
- 6a. To replace *Door Handle Type 1*, insert (4) screws and tighten.
- 6b. To replace *Door Handle Type 2*, place handle over dovetail buttons, making sure end marked TOP is up. Pull down to align handle holes, insert screws and tighten.
7. To replace trim, slide upper and lower trim pieces back on handle ends, and snap trim locks into holes on door front.

**NOTE:** Models with stainless steel handles are removed by peeling back rubber door gasket and then insert 1/4" Hex driver into (2) holes to remove (2) screws.

## DOOR REMOVAL

### FREEZER DOOR REMOVAL (ice & water models)

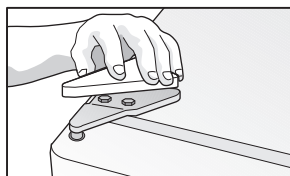

1. Lift off plastic top hinge cover (not on all models).

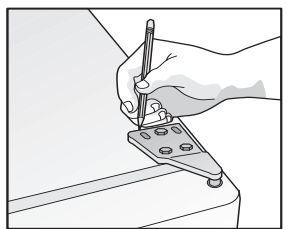

2. Trace around top hinge with soft lead pencil for easy relocation.

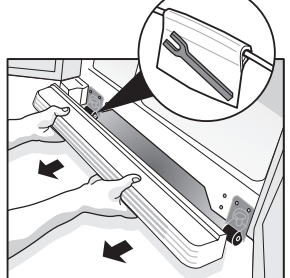

3. Grip right-hand corner and center of base grille and pull straight off.

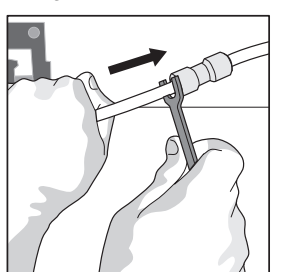

4. To disconnect water line, hold tube in left hand and use tool or 5/16" opened-end wrench to push in on gray collar to release connector. Tool located in bag under grille. See illustration #3.

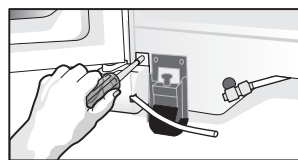

5. Remove hinge cover screw to remove cover.

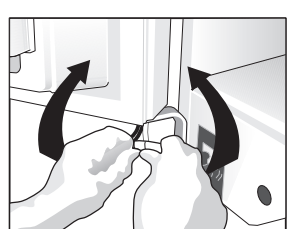

6. With thumbs on flat side, bend wiring connector to release lock, as shown.

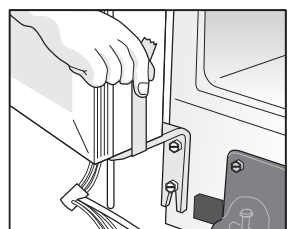

7. **IMPORTANT** Open door to its full position. **Tape lower hinge securely to door bottom.** Loosen but **DO NOT REMOVE** lower screw on bottom hinge. Remove top screw from bottom hinge.

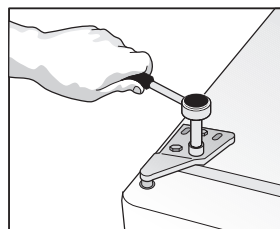

### TOP HINGE (overhead view)

8. Remove top hinge screws from refrigerator with a counter-clockwise motion. **NOTE:** Hinge has a minimal spring load. Hold bracket when removing last screw.

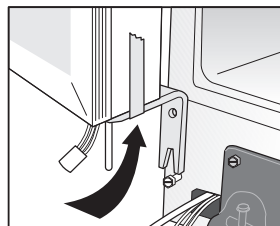

9. **IMPORTANT** Remove door with hinge attached, by lifting door up and off of bottom hinge screw.

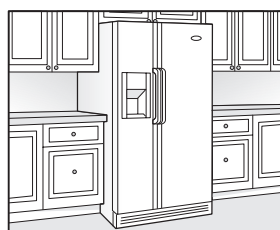

10. Set refrigerator in final location, reinstall doors with all shims and washers in original order and tighten bolts. **NOTE:** Do not over-tighten bolts.

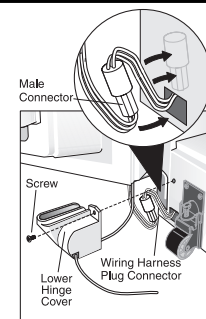

11. Reconnect wiring connector, making sure it is locked. **WARNING** To prevent electrical shock, fold wires as shown in figure above. Make sure male connector from door is pointing up. Insert tubing from door through access hole in lower hinge cover. Position cover over wires ensuring they are not pinched or exposed. Install screw to attach cover.

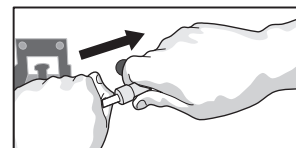

12. To reinstall water line connector, grip door tube firmly and push tube into connector until it touches the black mark on the tube and comes to a stop. **WARNING** This step is critical to ensure that the water line does not leak.



13. Check door alignment. Space between door and cabinet edge (gasket space) should be 3/4" at top hinge, the width of a penny.

### ALL OTHER MODELS

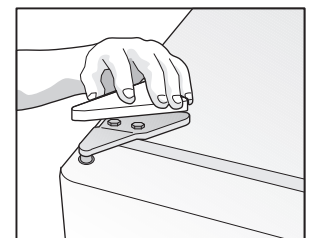

1. Lift off plastic top hinge cover (some models).

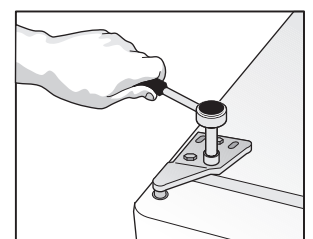

2. TOP HINGE (overhead view) Remove top hinge screws from refrigerator with counter-clockwise motion.

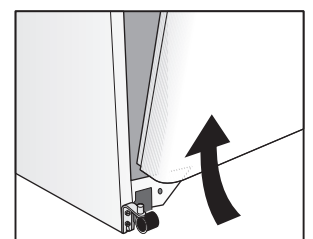

3. BOTTOM HINGE (side view) Lift refrigerator door off bottom hinge by removing grille and hinge mounting screws.

4. Follow steps 10 and 13 under "Freezer Door Removal for Ice and Water Models."

Refer to your *Owner's Use and Care Manual* for additional information about your refrigerator.

