

Instruction Sheet

for Ice Maker Water Inlet Tube Kit

Kit Contains:

- (1) Water Inlet Tube with Heater
- (1) Plastic Wire Tie
- (1) Jumper Wire
- (1) Piece of Tape
- (1) Supplemental Wiring Sheet (Insert)
- (1) Instruction Sheet

⚠ WARNING



Electrical Shock Hazard

Disconnect power before servicing. Replace all parts and panels before operating. Failure to do so can result in death or electrical shock.

1. Unplug the refrigerator or disconnect power.
2. Remove the grille by removing two (2) screws and opening the doors to 90 degrees. See *Figure 1*.

NOTE: Note position of doors while removing the grille. Doors must be at 90 degrees to remove grille.

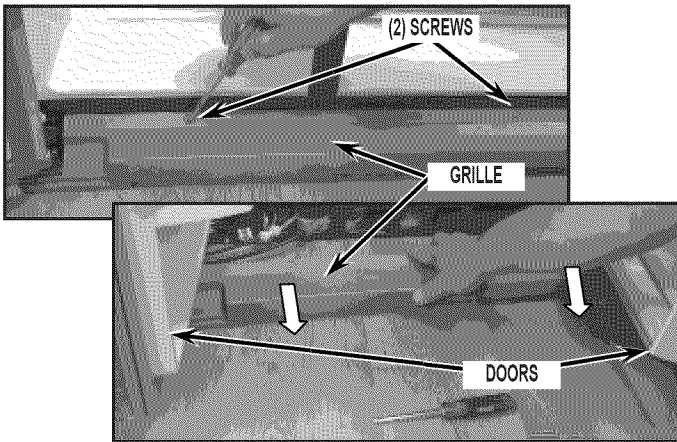

FIGURE 1

3. Disconnect the 1/4 inch water line at the connector in the grille area. See *Figure 2*.

NOTE: Have a towel handy to absorb any excess water.

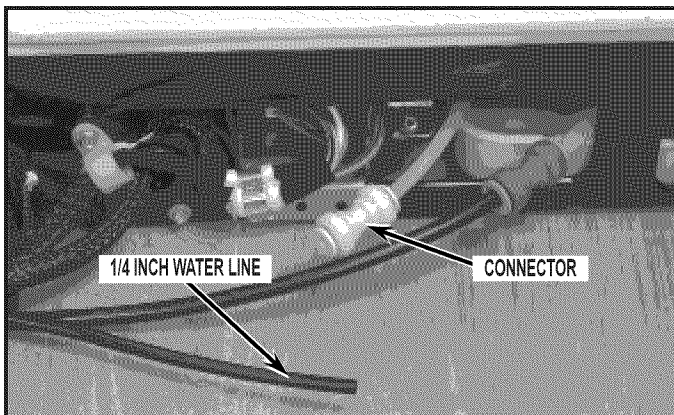

FIGURE 2

4. Securely tape an 8 foot piece of flexible wire or heavy string to the end of the 1/4 inch water line so you can pull the new 1/4 inch water line back through the door conduit. See *Figure 3*.

IMPORTANT: Be sure to wrap the ends securely and leave no exposed ends that might get hung up in the door conduit.

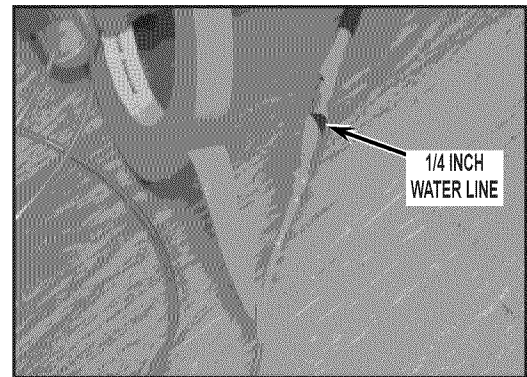

FIGURE 3

5. Remove user interface (UI). Method used depends on style of UI. See *Figure 4*.

- If UI is like Style 'A', remove UI by using a flat blade screwdriver from below to release three (3) locking tabs.
- If UI is like Style 'B', use a card or similar component to remove it by passing the card across the bottom of the UI, between the cavity where the UI is placed and the UI itself. Main lock is at the middle of UI. Do not remove any other component; it is not necessary to use screwdriver or any other tool. Pass the card several times if needed, the UI will detach almost by itself from cavity.

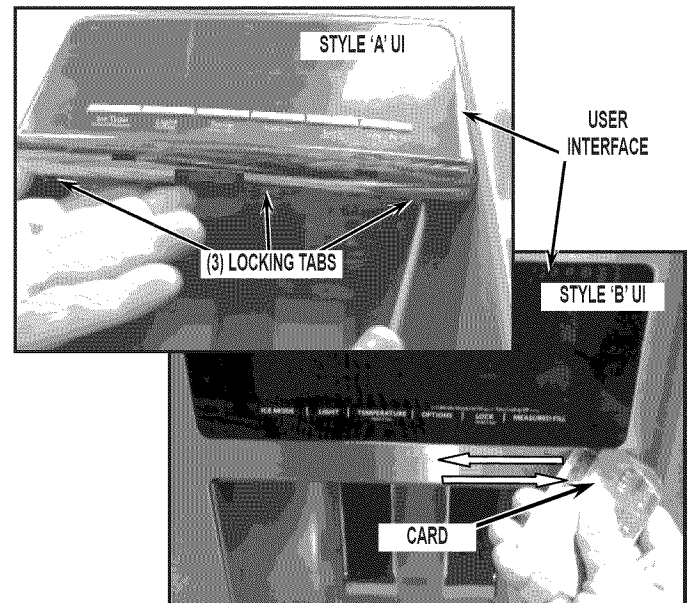

FIGURE 4

- Remove the wiring from the hook in the housing area behind the user interface. Unplug fill tube heater and optics wiring connectors so that the wires can move freely. See *Figure 5*.

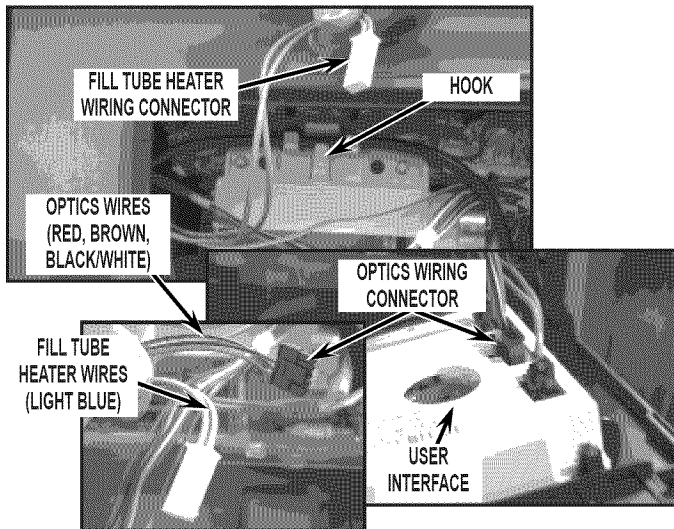

FIGURE 5

- Securely tape a 6 to 8 foot piece of flexible wire or heavy string to the fill tube heater wiring harness, optics wiring harness and connectors so that you can pull the new connectors and wire back through the door conduit. See *Figure 6*.

IMPORTANT: Be sure to wrap the ends securely and leave no exposed ends that might get hung up in the door conduit.

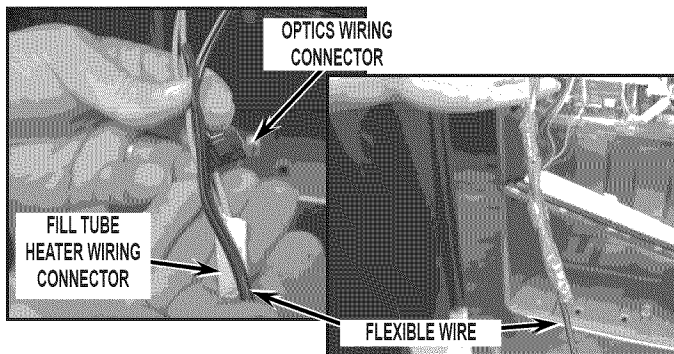

FIGURE 6

- Open the freezer compartment door, lift out the ice bucket. Remove the ice maker cover by removing two (2) screws. See *Figure 7*.

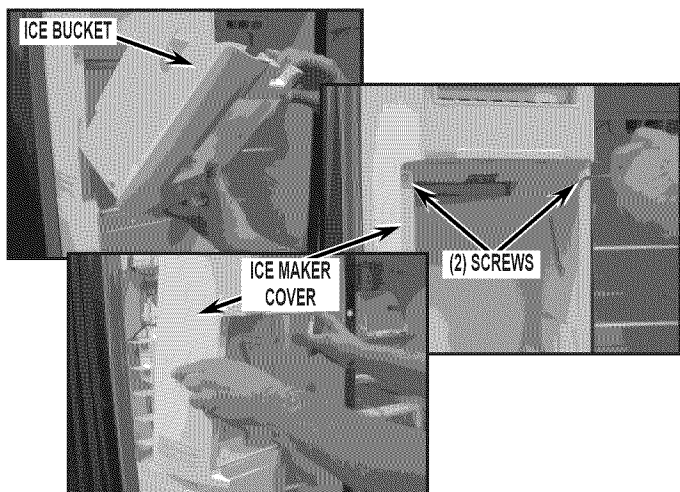

FIGURE 7

- Remove the optics wiring from the connector clip and two (2) hooks shown and unplug connector. See *Figure 8*.

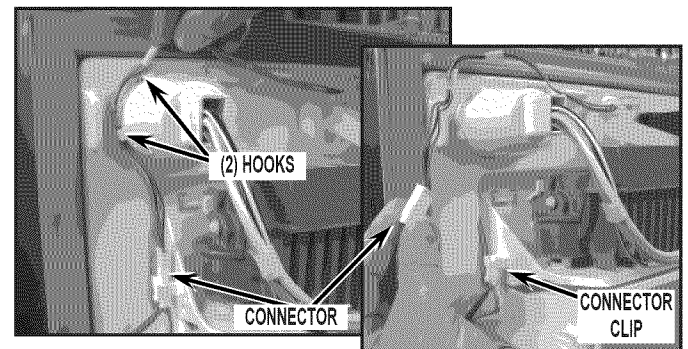

FIGURE 8

- Cut and discard wire tie that is holding fill tube in place. See *Figure 9*.

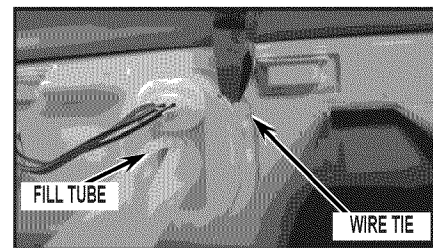

FIGURE 9

- Pull out the old fill tube and wire harnesses making sure to help feed the taped up sections up through the door conduit from behind the user interface and at the bottom of the door. See *Figure 10*.

IMPORTANT: Alternatively pull and push the old fill tube assembly out of the freezer door making sure not to pull off the taped up sections.

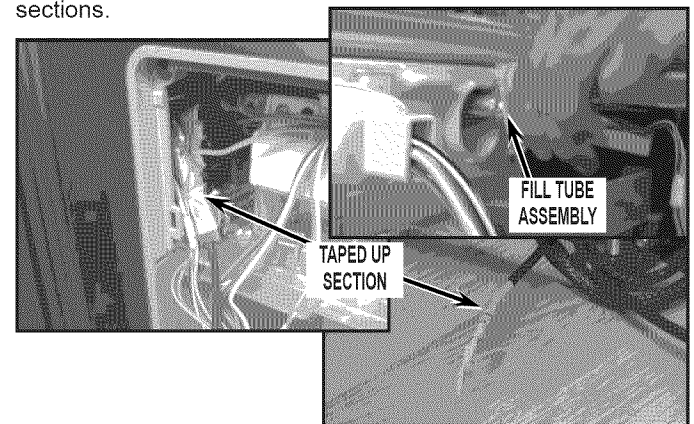

FIGURE 10

- Remove masking tape used for packaging from the new part. Attach the new 1/4 inch water line to the end of the correct piece of flexible wire or heavy string. See *Figure 11*.

IMPORTANT: Be sure to attach the new 1/4 inch water line to the end of the correct flexible wire or heavy string after removing the original part.

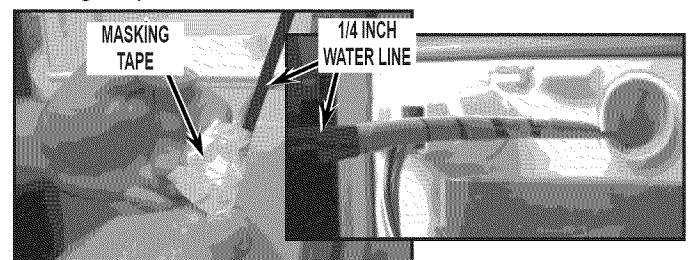

FIGURE 11

- Attach the wire harness connectors to the correct piece of flexible wire or heavy string after removing the original part. Start by attaching the optics wiring harness and connector to the end of the flexible wire or heavy string, then tape the fill tube heater wiring harness and connector separately. See *Figure 12*.

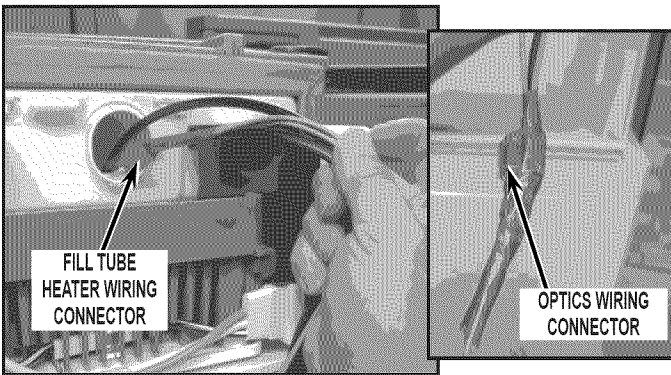

FIGURE 12

- Pull the water tube assembly and wire harnesses back into the door conduit as you alternately push on the assembly and pull on the ends of the flexible wires or heavy string in the housing area behind the user interface and the bottom of the hinge area.

IMPORTANT: Do not force the tube from above or you may crimp the tube.

- Snap the top and bottom of the fill tube into place. Apply wire tie to fill tube assembly, cut off excess wire tie and discard. See *Figure 13*.

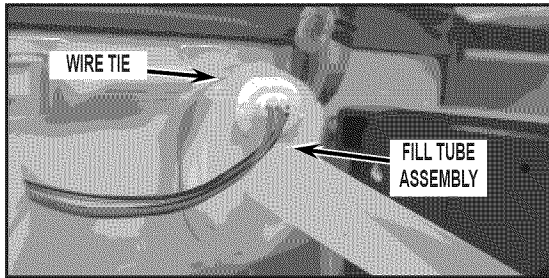

FIGURE 13

- Route optics wiring back into two (2) hooks, plug in the connector and attach to the connector clip. See *Figure 8*.
- Install ice maker cover ensuring the two tabs are secured in the mounting locations coming through the liner. Screw in the two (2) screws removed in step 8. Install the ice bucket.
- Plug optics wiring connector into the UI. See *Figure 5*.
- Disconnect the dispenser heater harness from its connectors. See *Figure 14*.

NOTE: The dispenser heater harness can be recognized by having "red portions" prior to connector.

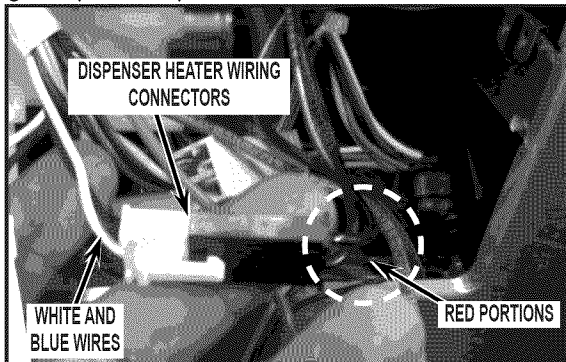

FIGURE 14

- Install "jumper". See *Figure 15*. Connect fill tube heater harness (2 pin connector) and dispenser heater harness (3 pin connector) into jumper. The opposite side of the jumper (3 pin connector) will be connected into the dispenser heater output harness.

NOTE: One connector (fill tube heater output-2 pin connector) will remain loose; wrap it with the supplied tape and route the wiring in the housing area behind the user interface as it was before the fill tube assembly was replaced. Insert 2 of the heater wire loops into the hook shown in *Figure 5*. Wrap up and place the excess wire into right corner of UI enclosure to avoid obstruction during UI re-assembly, tape to secure.

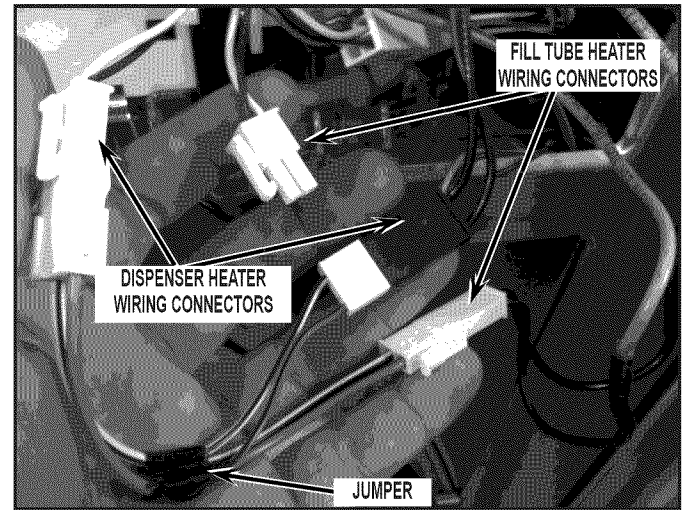

FIGURE 15

- Snap user interface back into place.
- Install the 1/4 inch water line back into the connector in the grille area.
- Place the supplemental wiring sheet (insert, provided) with the original tech sheet in the grill area to complete installation. Put grille back on and secure with two (2) screws.

⚠ WARNING



Electrical Shock Hazard

Plug into a grounded 3 prong outlet.

Do not remove ground prong.

Do not use an adapter.

Do not use an extension cord.

Failure to follow these instructions can result in death, fire, or electrical shock.

- Plug in refrigerator or reconnect power.
- Check for leaks, operation of ice and water dispenser and user interface.